

Instruction Manual of Sectional Steel Track

2 - Parts Steel Track

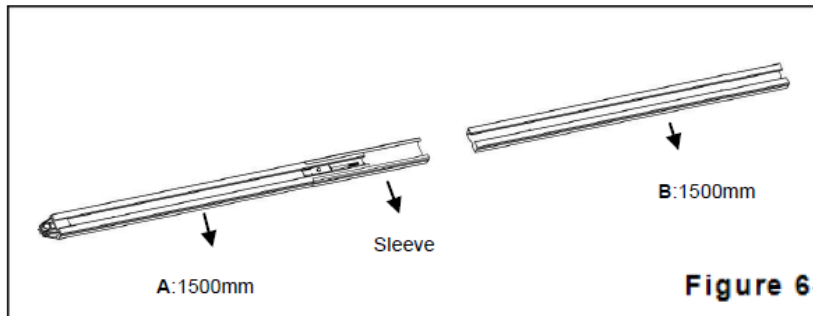

3 - Parts Steel Track

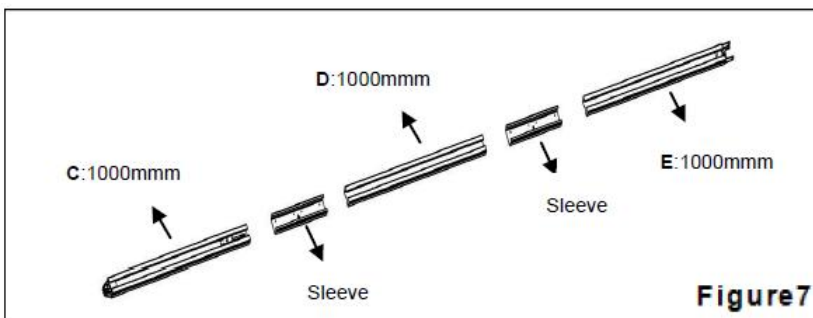

Step 1:

2 - Parts Track: As Fig.6, slide the A rail into the sleeve, slide the B rail into the sleeve.

3 - Parts Track: As Fig.7, slide the C rail into the sleeve, slide the D rail into the sleeve; slide the E rail into the sleeve.

Step 2: Cut the plastic thread; pull the screw rod along with inner chain/belt to the end rail position (Fig.8)

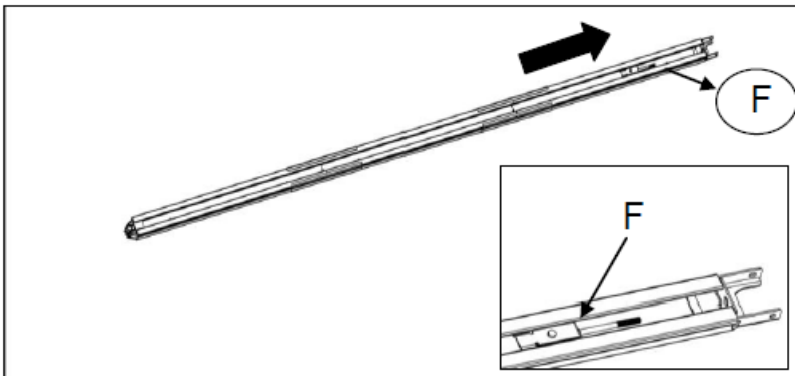

Figure 8

Step 3: As Fig.9, release the nut & spring.

Step 4: Tight the nut to the right position as shown in Fig.10, cut the plastic tape, cut the plastic thread on sprocket, then whole rail assembled finished.

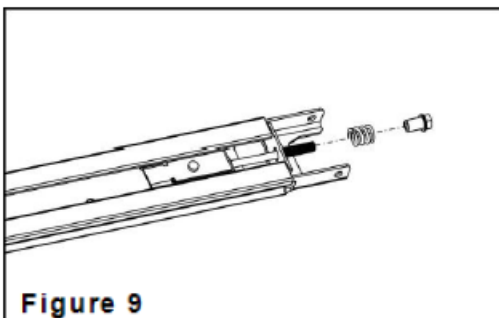

Figure 9

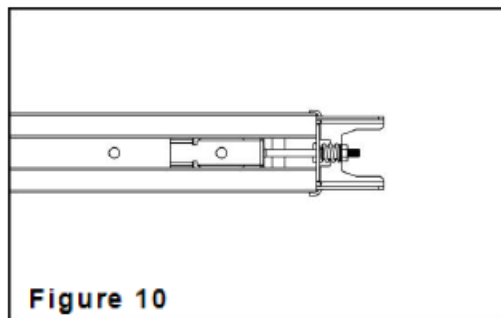

Figure 10

IMPORTANT!

After you have completed the sectional rail assembly and fitted the rail to the motor head, you will notice that the trolley key on the chain/belt is not visible.

The trolley key position is at the top of the rail assembly and should be moved to the “mid rail” position.

This can be achieved by performing the following step:

1. Turn the power on to the opener.
2. Press the set button for 3 seconds until number “1” starts to flash.
3. Press the set button again until number “1” stays on constant.
4. Press the down button until the trolley key (attached to the chain/belt) is at the half way position of the rail.
5. Turn the power off the opener and proceed to complete the install of the opener.